

POLYPIU[®]

POLYPIU[®]

POLYPIU[®]

PORTFOLIO

ITALIAN ENTREPRENEURSHIP AND FAMILY

Polypiù embodies the evolution of an entrepreneurial tradition rooted in Italian industry. Founded in 2006 by Domenico, Cristina and Elisabetta Moretti, the company carries on the legacy of Polyù Italiana Spa, established in the late 1970s by siblings Angelo and Vitale Moretti, pioneers in the European production of honeycomb polycarbonate systems. 2017 marked a strengthening of the link with the family roots through the entry of Andrea and Marco Moretti on the board of directors, ensuring continuity and a new impetus for the company, known for its commitment to innovation in the construction sector.



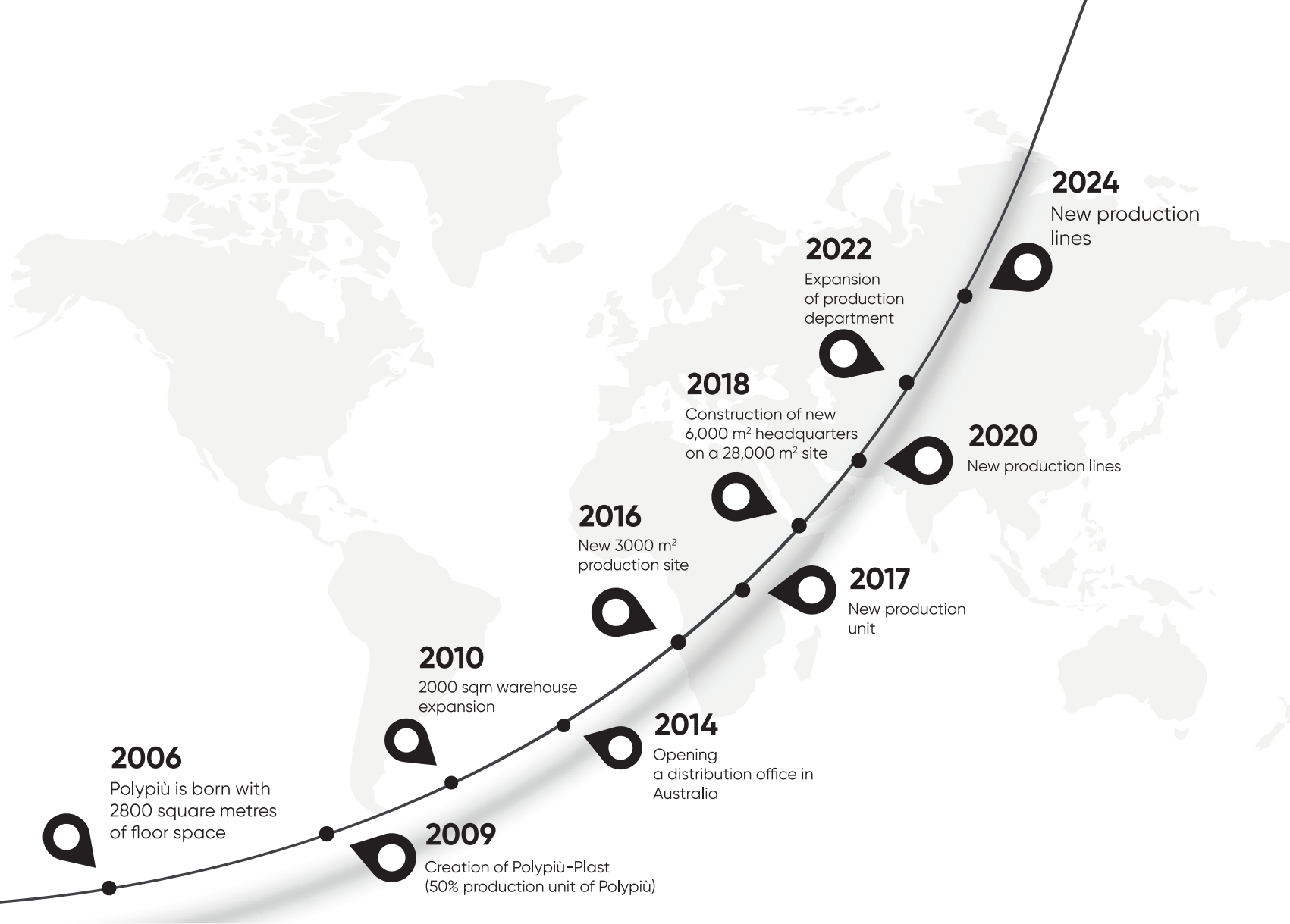

Today, **Polypiù** is a leading Italian manufacturer of polycarbonate systems and sheets, essential for roofing, curtain walling and industrial glazing. The company is a key partner for designers, installers and architects, offering effective, state-of-the-art solutions.

Looking to the future, Polypiù has expanded its international presence, opening new offices in Poland and Australia and increasing exports, which now reach 75 countries and account for 20% of total sales. In Italy, the historical pole in Corbetta has been joined by the new headquarters in Modugno (BA), strategic for relations with Southern Italy. Thanks to continuous investments in design and new production lines, **Polypiù** stands out on the market, responding promptly to customers' needs and anticipating industry trends.

THE DISTRICT OF POLYCARBONATE



Polypiù has transformed its **40,000** square metre industrial complex into the production heart of the polycarbonate industry, uniting management, business development, technical research, production and logistics under one roof. This industrial district represents a true hub of innovation and operational efficiency.

The head office coordinates the strategies that drive the expansion and consolidation of **Polypiù** as a market leader. The commercial department develops new markets and strengthens the international presence, while the technical department innovates through research and development of advanced polycarbonate solutions. The production line, equipped with state-of-the-art technology, ensures the highest product quality, while optimised logistics guarantee effective and timely global distribution. The Polycarbonate District has become a model of operational excellence, where every stage of the production process is integrated to accelerate innovation and improve business performance.



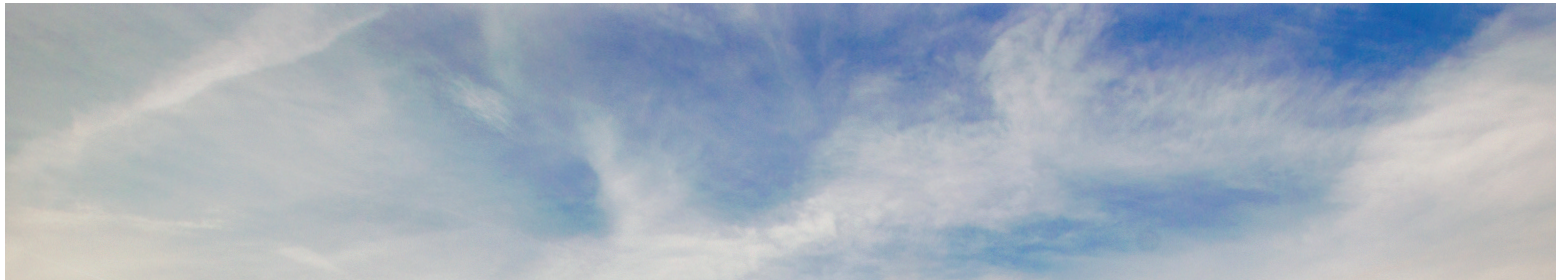

37 Million
of euro invoiced

+ 10 k
customers

+ 140
profili differenti

120
employees

75
countries in the world

9
extrusion lines



FLORIM CERAMICHE (2017) / Fiorano Modenese, Italia

The carpentry-built walkway and stairway was covered in the parapets and lower part with the Panelpiù 500/16 in a diffusing opaline colour, illuminated in the lower part with green LED. Thanks to the tongue-and-groove joint, the walkway appears as a continuous translucent element, providing a harmonious aesthetic effect with a strong visual impact.





PAVILLON BS.02 DUCATI (2022) / *Bologna, Italy*

An entire wall of the new pavilion dedicated to finishing aesthetic finish was realised with Panelpiù **500/65 14 Walls**, which gives a large amount of natural light inside the building, while ensuring high thermal insulation, which contributed to its NZEB certification.



PROJECT: *Luca Drago Architetti | Foto: Ducati*

Clear



Official
Supplier
2024



Panelpiù® 500/65 14 Walls

CONVERSE BANK (2023) / Yerevan, Armenia

Blue 60



Project: *Gravity*

Carbopiù® 10 mm

FRUITS GARDEN WAREHOUSE / *Verona, Italy*

Blue 60



Panelpiù® 500/40 5 Walls

PAVILLON ARTS & SCIENCES | GOLINELLI FOUNDATION (2017)

Bologna, Italy

For the realization of the façades of the Arts and Sciences Center at Golinelli Foundation, the product **Panelpiù 40 Matt** was used. The matt finish favours a more homogeneous diffusion of light, yet keeping the transparency, giving in this way a unique and stylish look to the building during night hours.

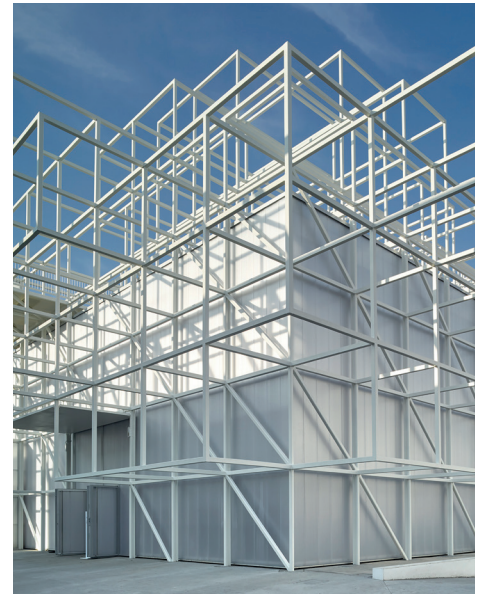

Panelpiù® 500/40 10 Walls

Project: *Mario Cucinella Architects*

Clear with Matte finish exterior

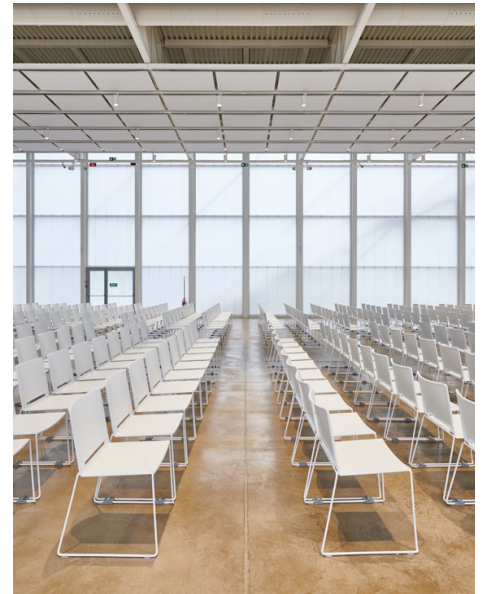

Restyling of waste-to-energy plant in Desio (2022) / Desio, Italy

The restyling of the Desio waste-to-energy plant involved the use of **Panelpiù 500/40** in the two-tone version, with one colour on the outer face and another on the inner face. The orange on the outside gives a bright colour note, the opaline on the inside allows more light to diffuse when the cladding is backlit in the evening. The longest panels measure 17.8 m.



Project: J+S – Concorezzo

Bicolor Orange 80 and Opal 35



Panelpiù® 500/40 5 Walls

Cabinet de Curiosités | Salone del Mobile (2023) / Milano, Italy

During the Salone del Mobile 2023, Annabel Karim Kassar with Annaka created an installation entitled 'Cabinet de Curiosités' in the Cortile d'Onore of the University of Milan. The material used in this project was **Ondapiù 177/51** in the thickness of 6mm and in yellow colour.

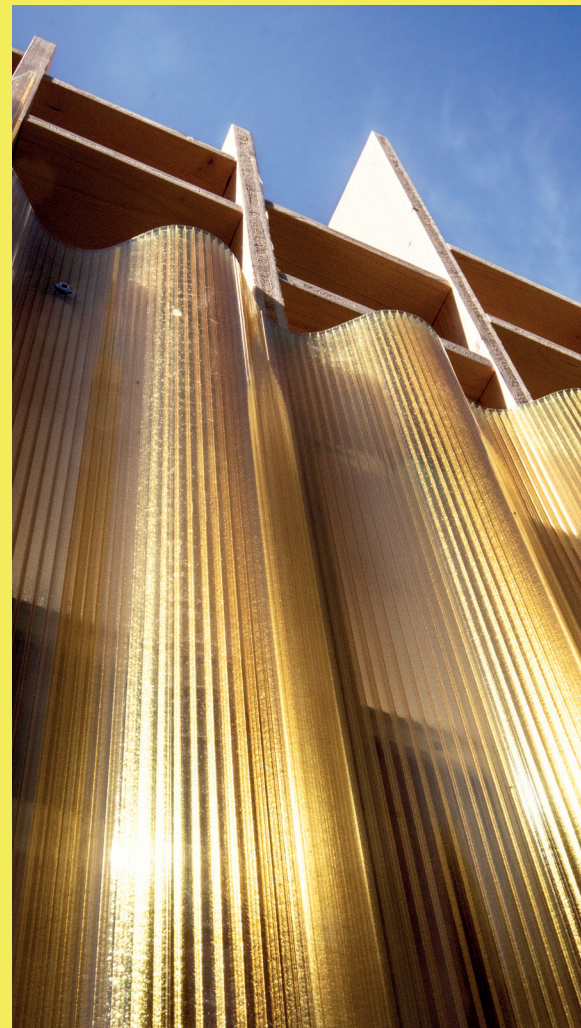

Project: Annabel Karim Kassar

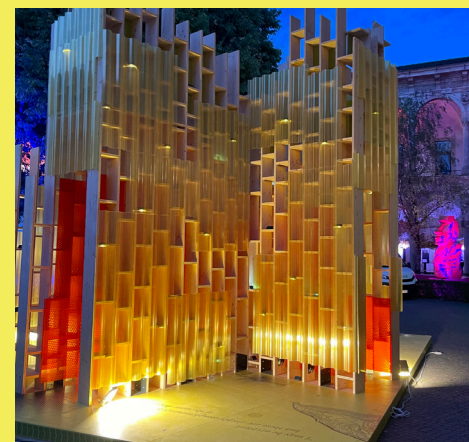

SCHOOL 'SCUOLA DEL SORRISO' / Lagosanto (Ferrara), Italy

Clear

Green 40

Green 6029



Panelpiù® 500/40 5 walls

SPORTS HALL (2023)/ *Brusaporto, Italy*

Opal 35



Project: A23C

Reverspiù® 600/20

LUAR FALL 2024 FASHION SHOW (2024) / *New York, USA*

The collaboration with AB Normal resulted in the set-up used for numerous fashion shows during New York Fashion Week in February 2024. The panel used is **Panelpiù 500/40 5 Walls**, neutral colour and matt anti-glare finish.

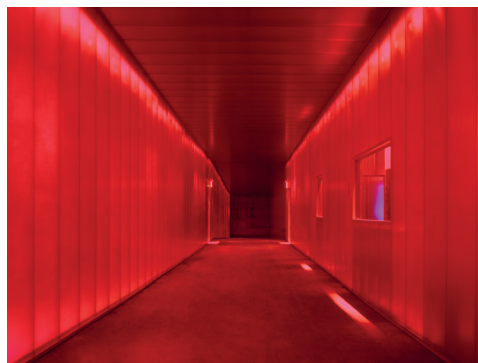

Project: (AB)NORMAL

Team: DAVIDE MASSERINI, MATTIA INSELVINI, LUIGI SAVIO, CAMILLA VAGHI

Photo: ANDREA CASAGRANDE

Clear with Matte finish exterior



Panelpiù® 500/40 5 Walls

PALAZZETTO DELLO SPORT (2024) / Olgiate Olona, Italy

The new gymnasium in Olgiate Olona is characterised by a translucent volume made of **Panelpiù 500/55 14 Walls**, mounted in a double skin, which injects diffused light and establishes a relationship with the sky, also thanks to its mimetic ability to reflect different colours and transform chromatically depending on the time of day. The double skin provides excellent thermal and acoustic insulation values



Project: *Arch. Giulia de Apollonia*

Team: Arch. Sara Donato, Arch. Chiara Galusi, Arch. Camilla Inverardi,
Arch. Silvia Favini, Arch. Gabriele Rognoni, Arch. Antonella Trusgnach

Clear



Photo: Filippo Poli

Panelpiù® 500/55 14 walls

BEECH TREES. THE MARE AND FOAL SANCTUARY (2022) / Devon, England

Clear



Panelpiù® 500/40 10 Walls

DENTAL HUB (2023) / Alzate Brianza, Italy

Opal 35



Project/Photo
Arch. Elena Rigamonti

Panelpiù® 500/40 10 Walls

CHESNUTS PRIMARY SCHOOL (2021) / UK

Multicolor



Systempiù®655/16

MANUFACTURING PLANT OF TEXTILES (2020) / *Olgiate Olona, Italy*

Clear

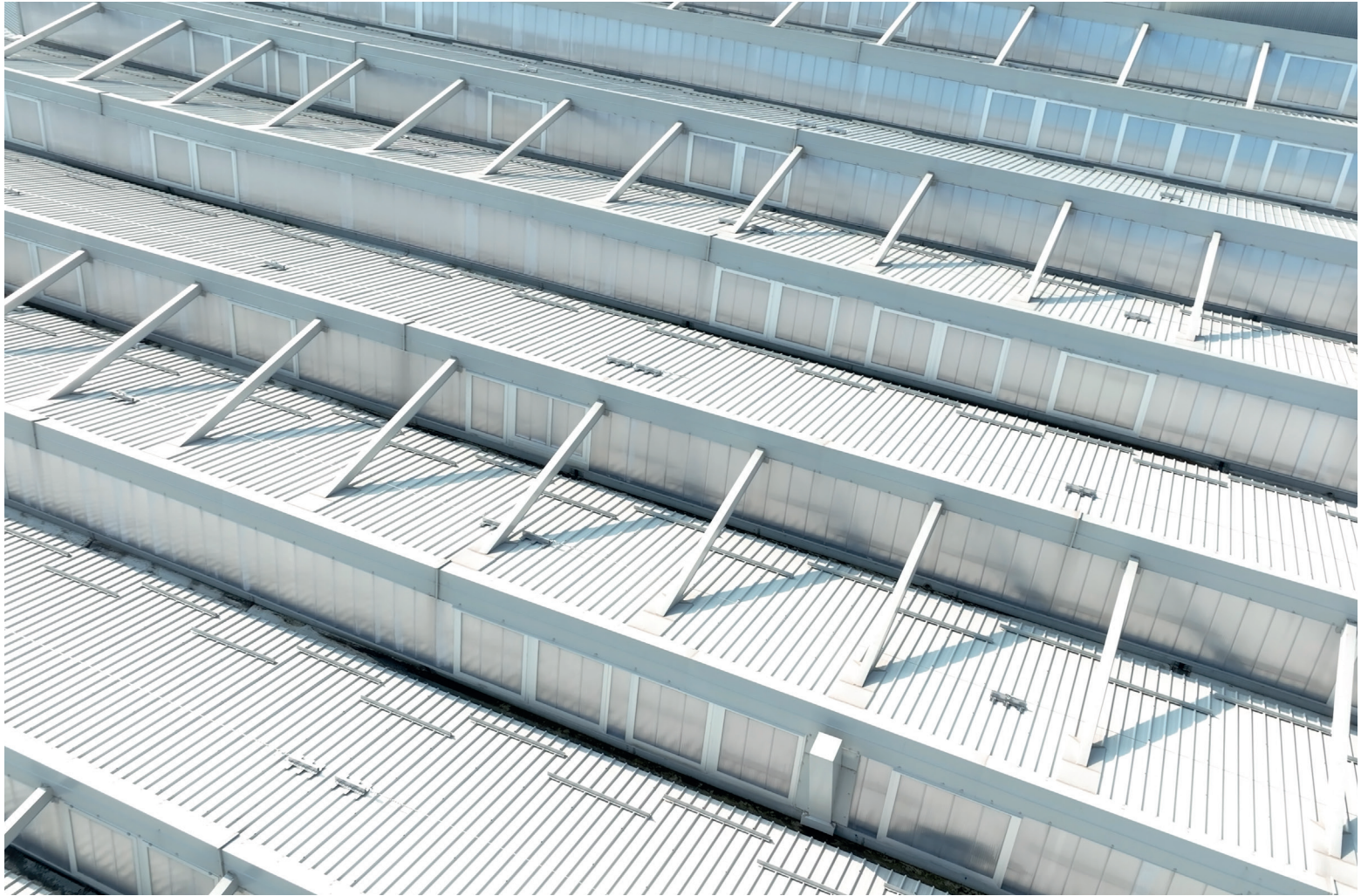

Panelpiù® 500/40 10 Walls

AÉROPORT MARSEILLE PROVENCE (2022) / Marsiglia, France

Clear

Green 40

Yellow 71

Orange 80

Red 71

Grey 90



Reverspiù® 655 20 mm

AEROPORTO DE RIBEIRÃO PRETO (2023) / Ribeirão Preto, Brazil

Clear

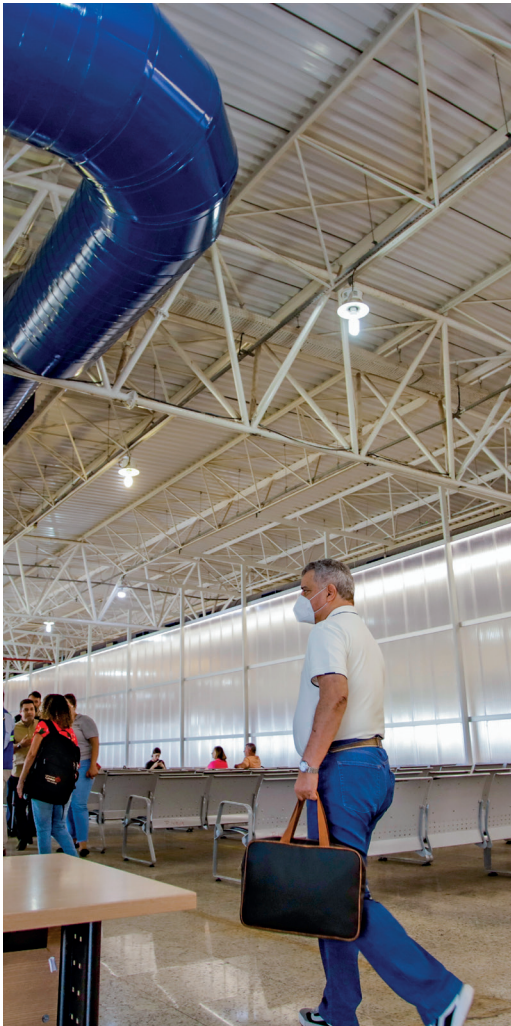

Photo: Guilherme Sircili

Panelpiù® 500/40 5 Walls

ENHANCE | DESIGN WANTED EXHIBITION (2024) / Milan, Italy

Clear



Project: E20PROGETTI

Photo: Alessandra Palumbo

Panelpiù® 500/40 5 Walls

LONDON RIVIERA (2015) / London, England

Yellow 71

Orange 80

Red 71

Purple 99

Blu 60



Systempiù® 655/16 mm

STADIO ATLÉTICO MINEIRO (2023) / Belo Horizonte, Brazil

Opal 35

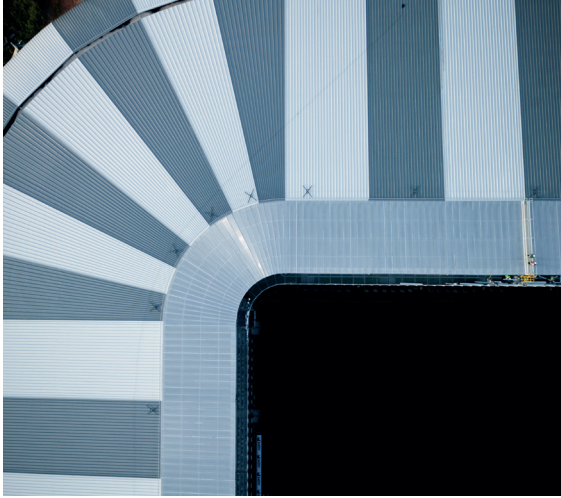

Carbopiù® 20 X Structure

COMPLEX OF VIALE STEPHENSON 94 (2021) / *Milano, Italy*

Opal 35



Panelpiù® 500/40 5 Walls

Project: *Studio Nozza*

SESTAO PARK (2021) / Sestao, Spain

Opal 35

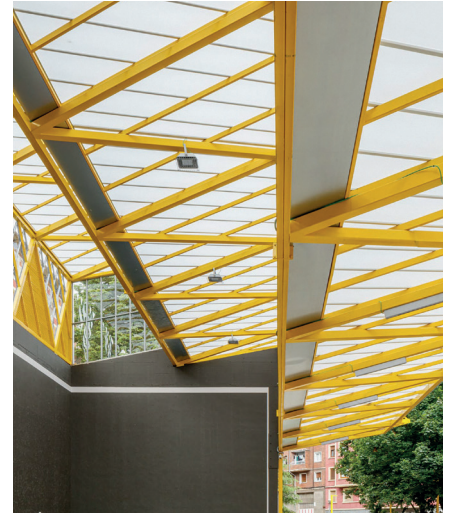

Systempiù® 655/16 mm

STADIUM EL SADAR (2020) / Pamplona, Spain

Opal 35



Grecaپیù® 40/10 5 greche

BORSONI THEATER (2024)/ *Brescia, Italy*

In the revitalisation project for Brescia's Porta Milano district, the Borsoni Theatre plays an important role. Its stage tower has been clad, on two sides, with **Panelpiù 500/40 10 walls**. The panels have a length of 10 m and the opaline colour allows the backlighting of the wall facing the theatre entrance to be more diffuse.

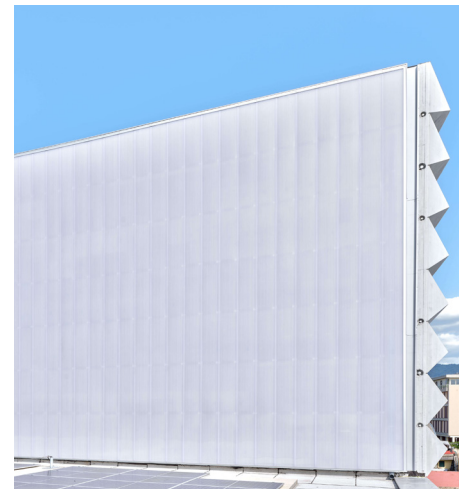

Project: BOTTICINI + FACCHINELLI ARW
Photo: ©FEDERICO COVRE ARCHITECTURAL PHOTOGRAPHER

Opal 35



Panelpiù® 500/40 10 Walls

MIU MIU FASHION SHOW (2023) / Paris, France

White opal



Ondapiù® 177/51

STABLES (2023) / Poland

Clear



Panelpiù® 500/40 5 Walls

ARCHITECTS REGISTRATION BOARD (2000) / London, UK

Clear



Project: *dRMM Studio*

Ondapiù® 177/51 6 mm

SPRING/SUMMER 2016 PRADA FASHION SHOW (2015) / *Milan, Italy*

Clear



Project: OMA/AMO

Smartpiù® and Lightpiù®

MACEF EXPO(2011)/ Milan, Italy

Blu 60



Grecafiù® 5 greche 40/10 mm

BUSINESS CLUB EXPO RIVA (2023) / *Riva del Garda, Italy*

Blu 60



Panelpiù® 500/40 5 Walls, Lightpiù® Luxe e Carbopiù®

LA FABBRICA DEL FUTURO (2023)/ *Brescia, Italy*

Temporary pavilion to host an exhibition dedicated to the excellence of Brescian entrepreneurship. Made with **Panelpiù 500/40** opaline, mounted in a double wall to improve thermal and acoustic insulation, while maintaining the translucency of the entire object. The same panel was used both for the walls and for the roof.

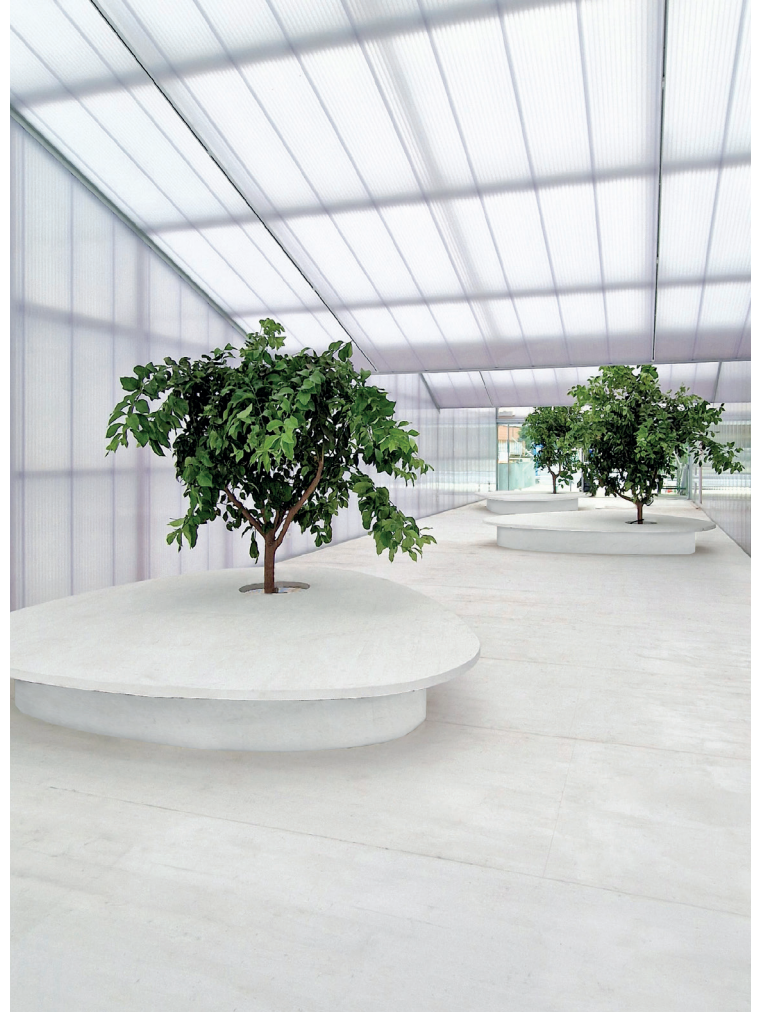
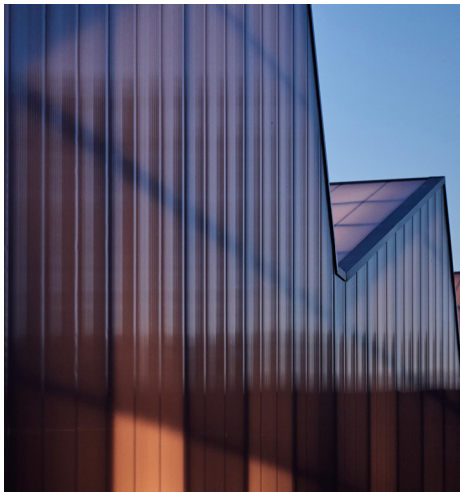

Project: BOTTICINI + FACCHINELLI ARW
Photo: ROSAMARIA MONTALBANO + STEFANO ANDREATTA

Opal 35



Panelpiù® 500/40 5 Walls

LA GELATERIA ITALIANA (2023)/ Vienna, Austria

Green 40



Project: *Genuizzi + Banal Architetti*

Panelpiù® 500/40 5 Walls

BLZ SHOP (2024)/ Brazil

Opal 35



Panelpiù® 500/40 5 Walls

ANTHOS | POLIMODA GRADUATION SHOW (2023)/ Firenze, Italy

Clear with Matte finish

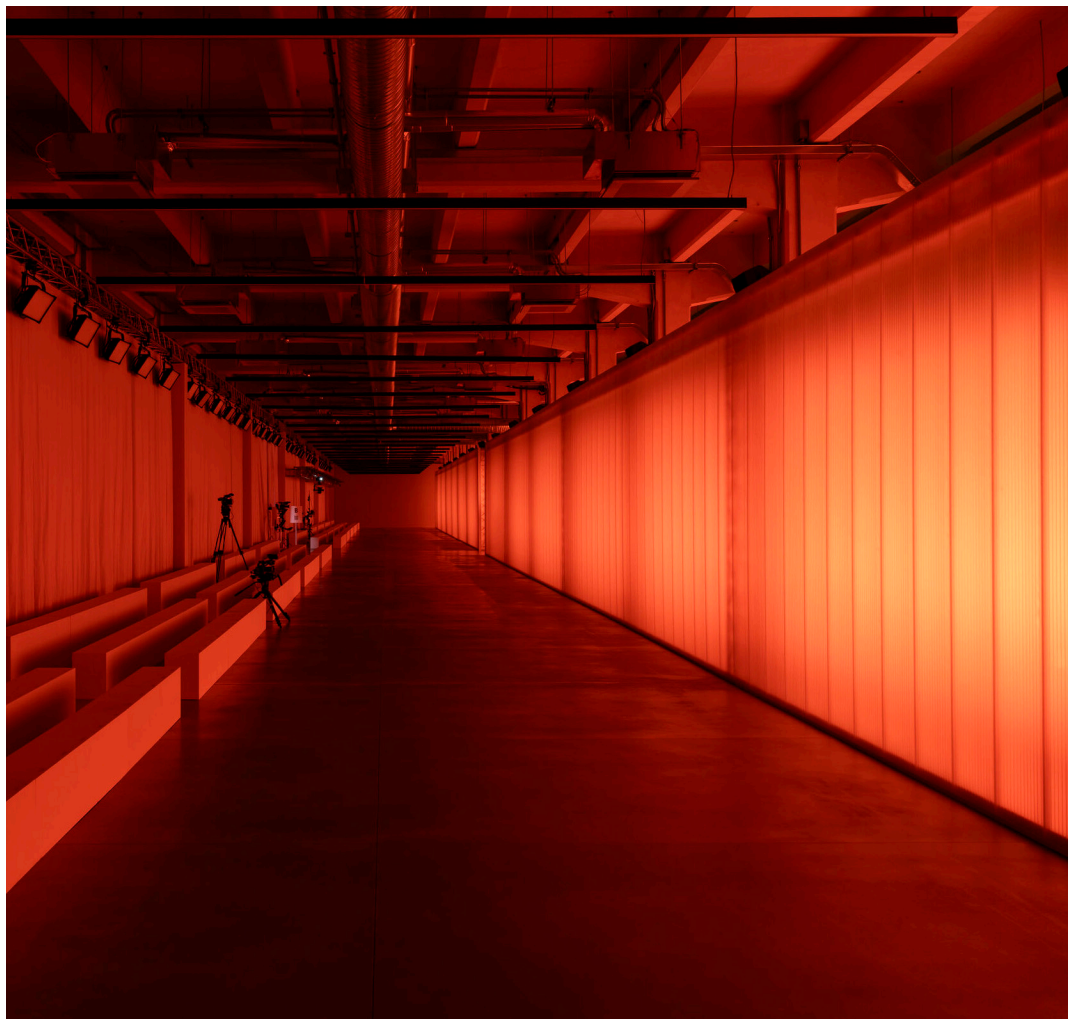
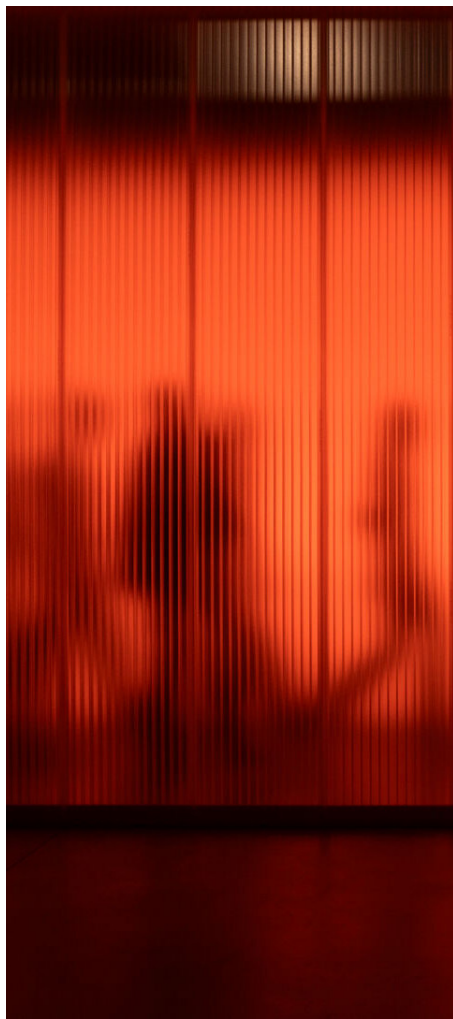

Project: (AB)NORMAL

Photo: Riccardo Giancola

Panelpiù® 500/40 5 Walls

CAPANNONE 15/B PARCO INNOVAZIONE REGGIANE (2024)/ *Reggio Emilia, Italy*

Opal 35



Project: ZAMBONI ASSOCIATI ARCHITETTURA CON CAIREPRO

Photo: ©ZAMBONI ASSOCIATI ARCHITETTURA ©KAI-UWE SCHULTE-BUNERT

Panelpiù® 500/40 5 Walls

CAPANNONE 15/C PARCO INNOVAZIONE REGGIANE (2024)/ *Reggio Emilia, Italy*

The Pavillion Host the multimedia classrooms and laboratories for the University of Reggio Emilia, separated by a covered square in the centre of the complex by a double wall in polycarbonate, made with our Panelpiù **500/40 5 Walls** opaline coloured. The double wall improves thermal and acoustic insulation and ensures continuity and uniformity on both sides, concealing the load-bearing structure.

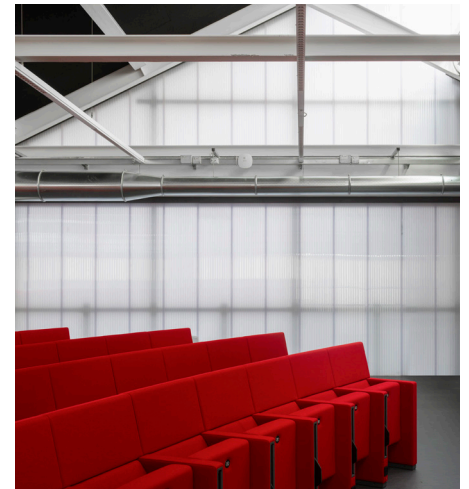
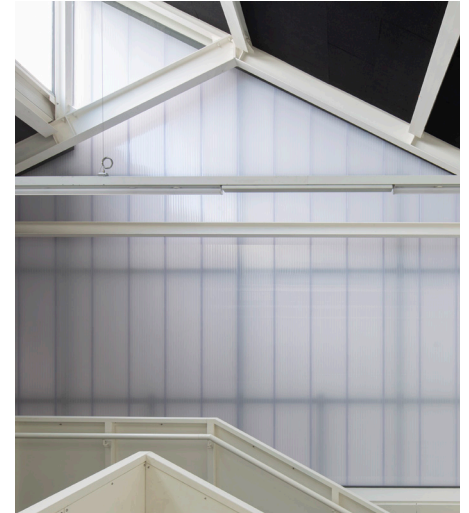

Project: ZAMBONI ASSOCIATI ARCHITETTURA CON CAIREPRO
Photo: ©ZAMBONI ASSOCIATI ARCHITETTURA ©KAI-UWE SCHULTE-BUNERT

Opal 35

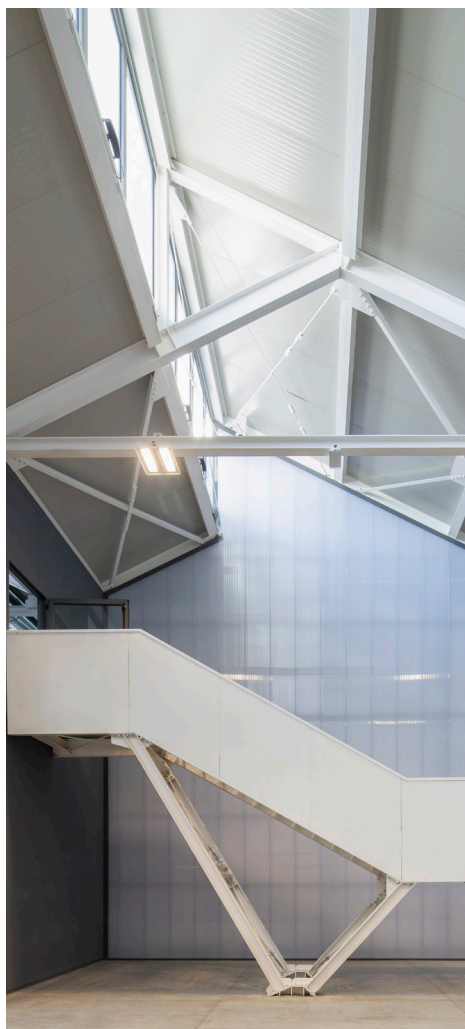

Panelpiù® 500/40 5 Walls

34 BIENAL DE ARTE DE SÃO PAULO (2021)/ *Brazil*

On the occasion of the 34th São Paulo Art Biennial, the **Smartpiù onda 76/18** sheet was used to create interior walls. Thanks to its high degree of flexibility, this slab is able to adapt to the soft lines drawn by the designer and, in addition to bringing in natural light, acts as a guideline for visitors' eyes.

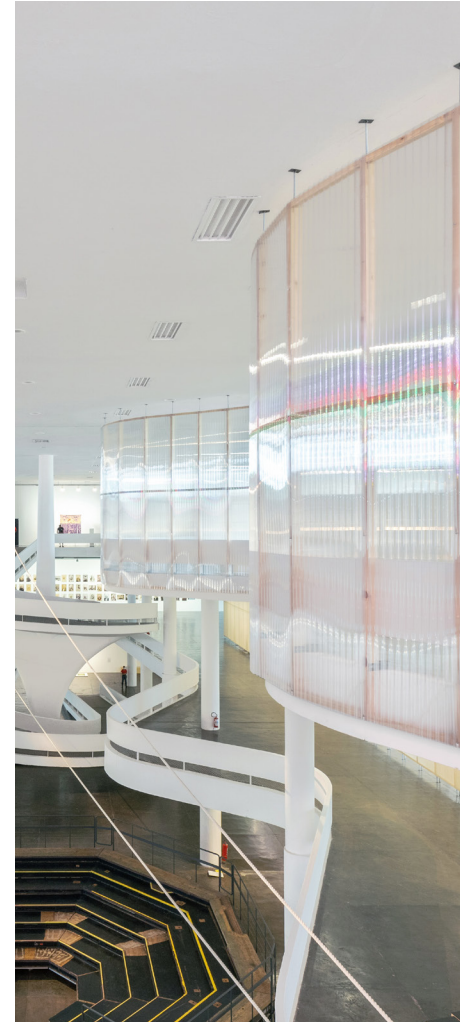



POLYPIU®

POLYPIU: Innovazione ed eccellenza nel policarbonato. Scopri Polypiu, leader nel settore dei materiali in policarbonato. Con la nostra tagline "Reimagine Colors", ci impegniamo a superare i limiti tradizionali, offrendo soluzioni innovative e di alta qualità per architetti e designer. Grazie alla nostra esperienza consolidata e alla costante ricerca di innovazione, garantiamo prodotti affidabili e versatili per l'edilizia industriale, commerciale e civile.

Fondata nel 2006, Polypiu incarna l'eccellenza dell'impresa familiare italiana, ereditando una tradizione radicata nel settore industriale. Con una presenza internazionale in costante crescita, offriamo soluzioni avanzate in policarbonato per una vasta gamma di applicazioni, dalla produzione di lastre e sistemi a progetti architettonici di design.

La nostra sede centrale, un vero e proprio hub industriale, coordina ogni fase del processo produttivo, garantendo innovazione, efficienza operativa e qualità ineguagliabile. Il nostro Dipartimento Tecnico sviluppa trattamenti speciali per migliorare le prestazioni del policarbonato, anticipando le esigenze del mercato e offrendo soluzioni all'avanguardia.

Con il nostro impegno per l'innovazione, il rispetto dell'ambiente e l'eccellenza operativa, Polypiu è pronta a plasmare il futuro del settore dei materiali in policarbonato, guidando l'industria verso nuove frontiere di eccellenza e innovazione.

Corbetta

Via A. da Giussano, 15
20011 Corbetta (MI)
polypiuinfo@polypiu.it
+39 02 9748371
Fax +39 02 97483799

Modugno

Strada statale 96 km 116,
70026 Modugno (BARI)
polypiuinfo@polypiu.it
+39 08 05367403

Melbourne

42 Sarah St.
Campbellfield VIC 3061
Melbourne (Australia)
sales@polypiu.com.au

Czeladź

Polyxo Sp. z o.o.
ul. Nowopogońska 98
42-250 Czeladź (Polonia)
+48 734 850 201
+48 734 850 202

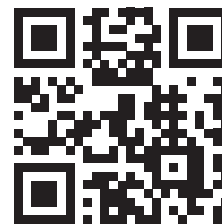

www.polypiu.it

PORTFOLIO

www.polypiu.it

www.polypiu.it